



EFX



APP



Wireless



Lithium Battery

Electric Guitar

VP2200/VP2210

User Manual

使用说明书

www.soranaudio.com



Made In China

Ji You Technology Co.,Ltd

Note: This manual is applicable to the current firmware version. We will also continuously upgrade and launch personalized user voice libraries. Please pay attention to other contact information such as the official website or public account. For detailed operation methods, you can also watch the device introduction videos.

注：此说明书适用于当前固件，我们也将不断升级并推出个性用户音色库，请留意官网或公众号等其他联系方式。详细操作方式还可观看设备介绍视频。

Contents

1. Introduction to Guitar Components 01

2. Introduction to Guitar Control 03

 Analog Section (Electric Guitar Functions) 03

 Digital Functions (Effects Circuit) 03

 Side Control Panel Functions 04

 Device Connection 04

3. Guitar Adjustment and Maintenance 05

 Pickup Combination Method 05

 Volume and Tone 05

 Guitar Pitch Adjustment 05

 Adjustment of the Truss Rod..... 06

 Guitar Action Adjustment 06

 Intonation Adjustment 06

4. Software User Instructions 07

 a) Main Interface 07

 b) Software Basic Settings 07

 c) USB Audio Settings 07

 d) BT Wireless Parameter Settings 07

 e) Tuner Settings 08

 f) IR Import/Export 08

 g) Basic Information of Presets 08

 h) Import, Export, Save, Reset, and Volume 08

 i) User Banks and the Corresponding Presets Within the Banks 09

 j) Effect Chain Module, Associated with Guitars and Effect Module Parameters 09

 k) Save Presets 10

 l) Reset 10

 m) Drum Machine 10

 n) Jam Track 11

5. Specifications 12

6. Effect List 13

Front

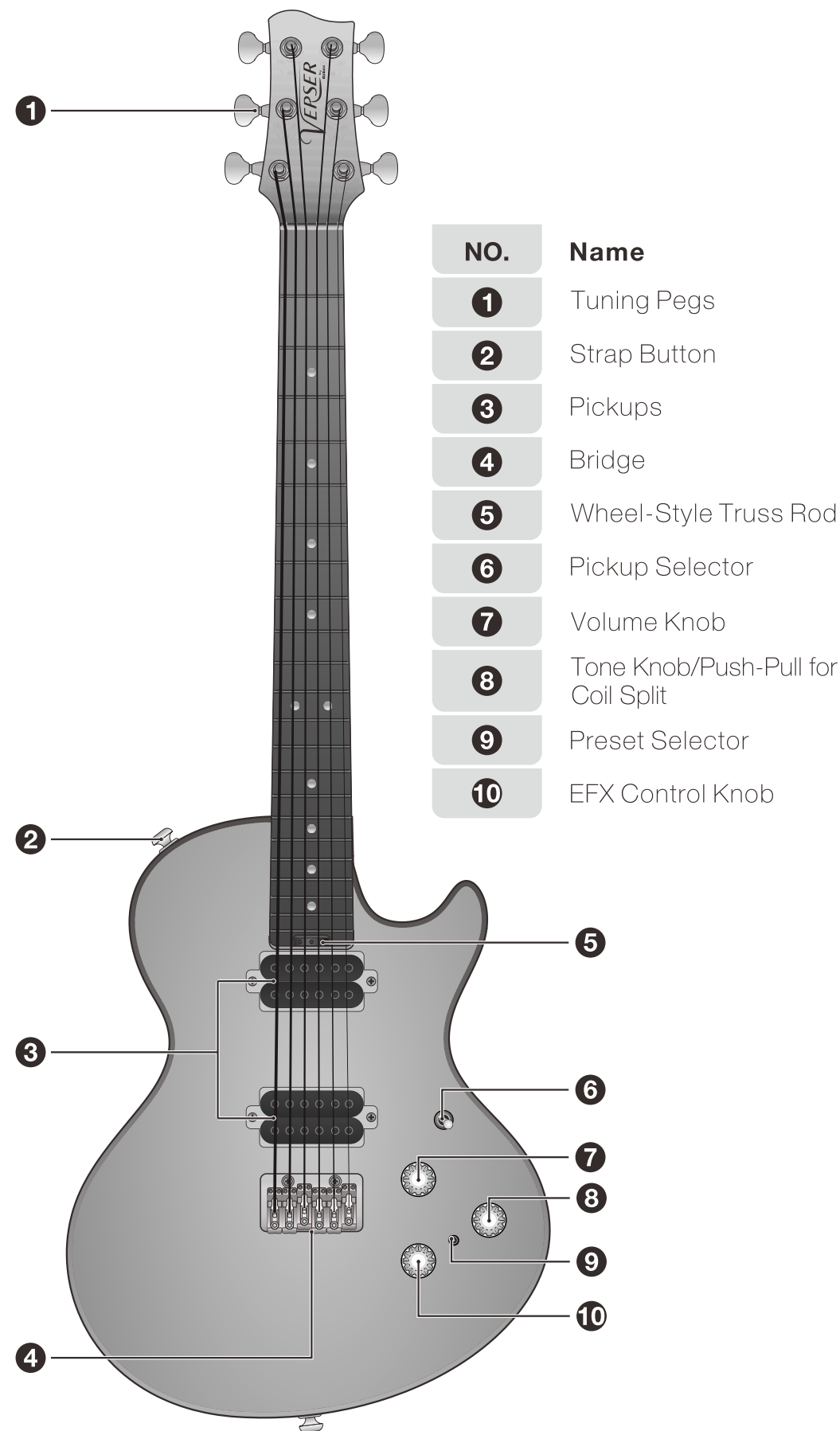

Back/Side Control Panel

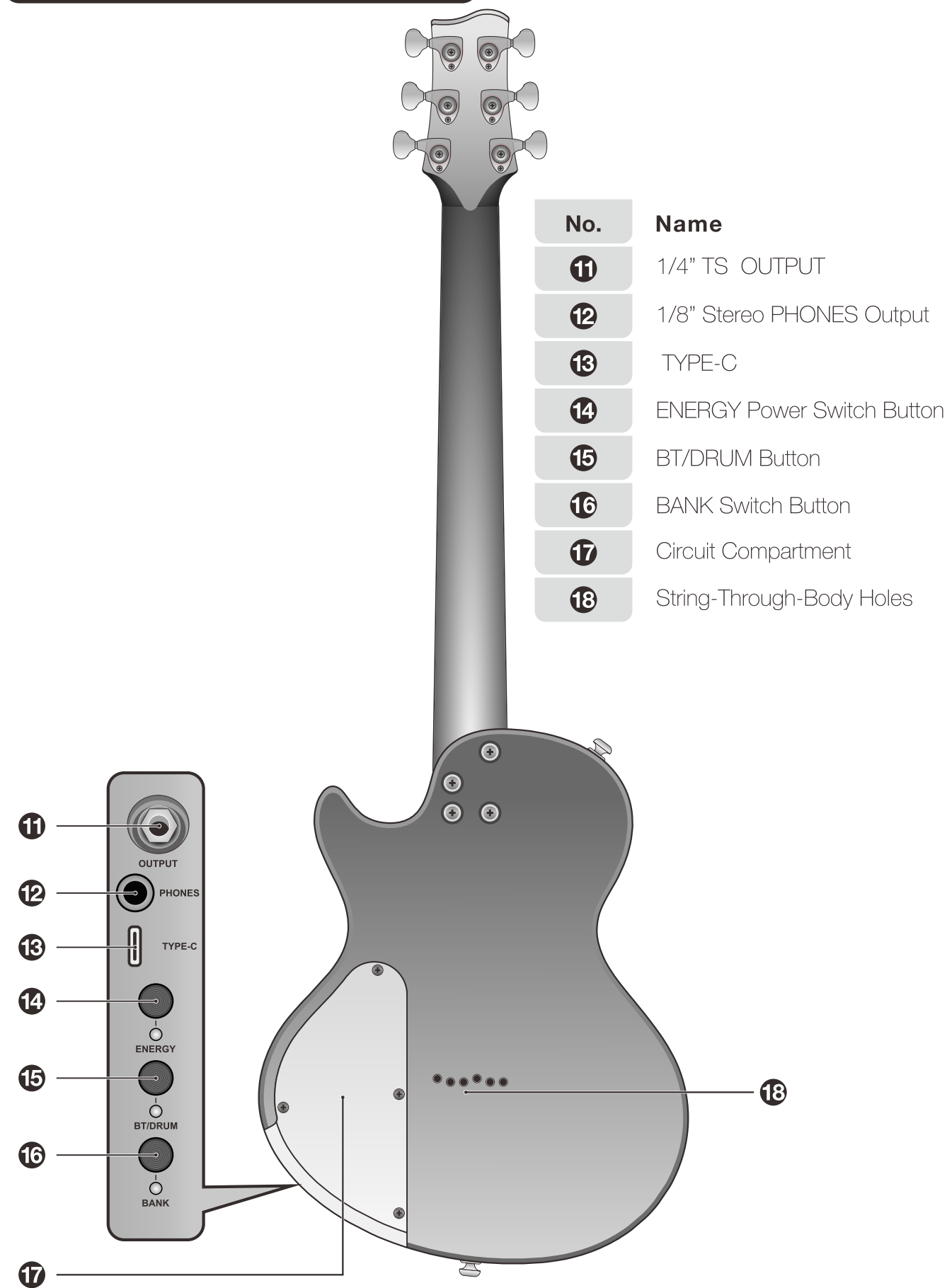

2. Introduction to Guitar Control

Analog Section (Electric Guitar Functions)

- 1 Tuning Pegs**
Adjusts the tightness of the strings to change the pitch of the guitar.
- 2 Strap Button**
Secures the strap in place.
- 3 Pickups**
A device for picking up signals.
- 4 Bridge**
A string-adjusting bridge assembly that allows for fine-tuning both string height (action) and effective string length (intonation), improving playability and pitch accuracy.
- 5 Wheel-Style Truss Rod**
Adjust the curvature of the neck.
- 6 Pickup Selector**
Three-position pickup selector switch for neck, bridge, or combined pickup settings.
- 7 Volume Knob**
Adjust the output volume of the guitar.
- 8 Tone Knob/Pull for Coil Split**
Adjusts the tone of the guitar/push-pull for coil split.

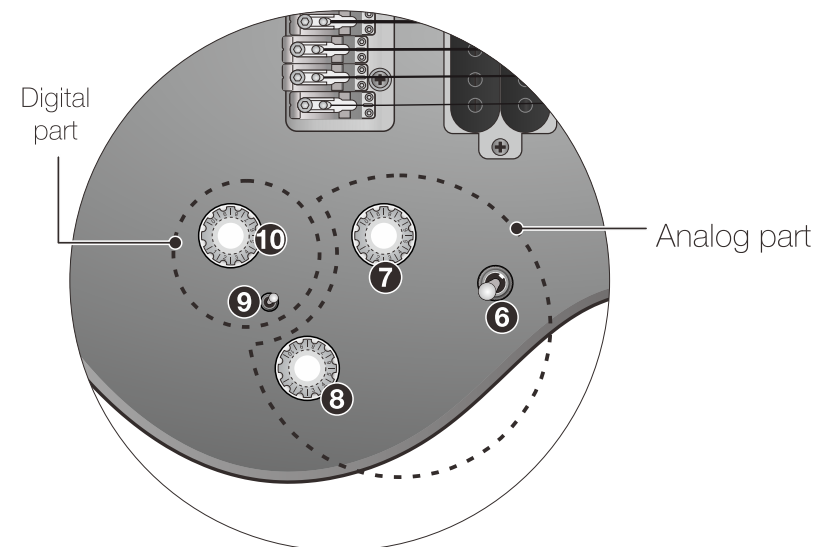

Digital Functions (Effect Circuit)

- 9 Preset Selector**
The 3-way switch (switch A\B\C preset). Example: Ticking Bank 1 corresponds to three presets of A\B\C under Bank 1.
- 10 EFX Control Knob**
Press and hold the ENERGY button for 2 seconds to activate the effect module.
Select and send effect chain modules and drum machine to the EFX encoder through the App (EQ excluded).
Press and hold the EFX control knob for 2 seconds to switch between modules assigned to the EFX encoder.
Rotate the EFX control knob to adjust current module parameters (Gain for Amp module, rhythm types for Drum Machine).
EFX module indicator lights match corresponding App colors for identification.
Press and hold EFX control knob for 3 seconds to save current preset(white flash = saved).

Side Control Panel

- 11 1/4" TS Output**
1/4" TS output for connecting to an amp, PA system, or external effects.
- 12 1/8" Stereo PHONES Output**
1/8" stereo output for connecting headphones or other audio equipments.
- 13 TYPE-C**
USB Type-C port enables USB audio streaming, firmware updates, and mobile OTG connectivity.
- 14 ENERGY Power Switch Button**
Long press function: Long press for 2 seconds to activate the effect module;
Short press function: After the effect module is activated, briefly press the ENERGY button to activate the Bypass mode.
Reboot function: When the equipment is in an abnormal operating state, it can be restarted by long-pressing the ENERGY and BANK buttons.
- 15 BT/DRUM Button**
Short press function: Turn on/off the drum machine;
Long press function: Turn On/Off BT wireless for 1.5 seconds (BT Wireless is turned off by default upon startup).
- 16 BANK Switch Button**
Short press function: Display the corresponding color indicator light of the current Bank.
Long press function: Long press for two seconds to change groups, and the color will change to the corresponding Bank indicator light.
Select 1 to 7 preset groups in the software and assign them to the bank for easy step-through switching.

Device Connection

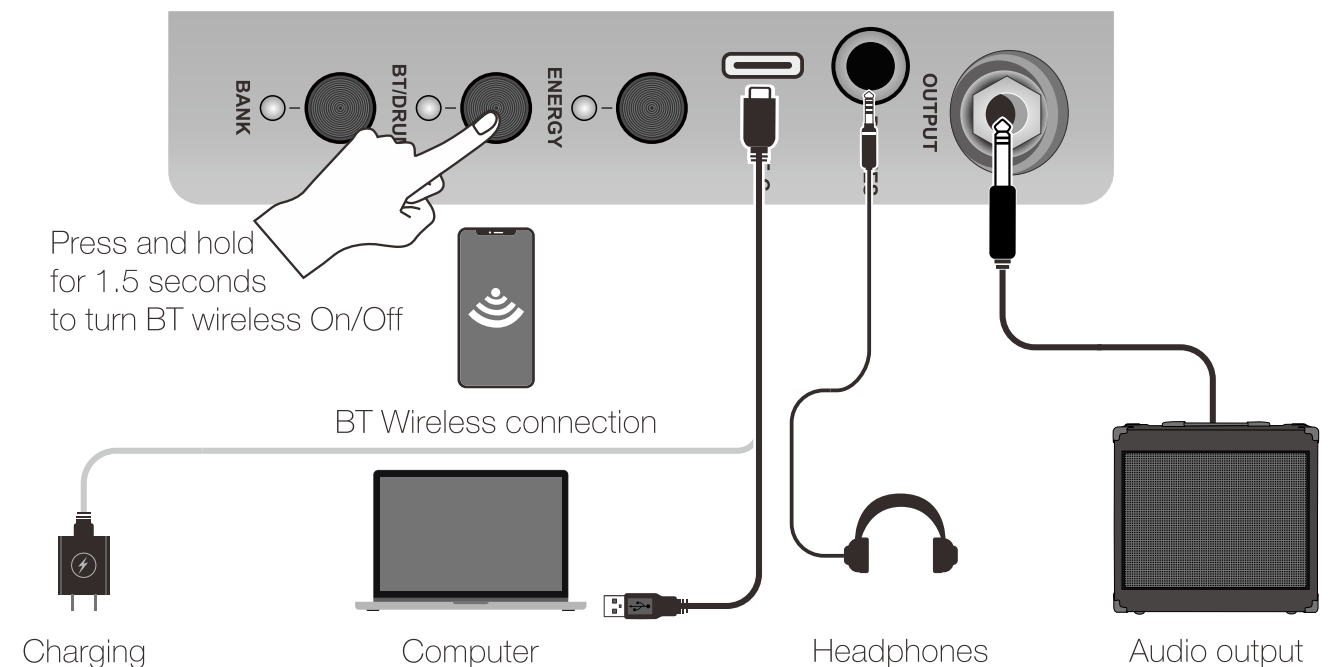

3. Guitar Adjustment and Maintenance

Pickup Combination Method

You can use the **[Pickup Selector]** to choose between three pickup positions. You can also pull up the **[Tone Knob]** to activate the coil split.

Standard Mode

When the coil split is not activated, the 3-way pickup status (see the figure below).

Neck pickup position

Middle pickup position

Bridge pickup position

Neck pickup position:	Middle pickup position:	Bridge pickup position:
Two pickups are activated near the neck of the guitar.	All four pickups are activated.	Two pickups are activated near the bridge of the guitar.

Coil Split Mode

When you want to activate the coil split, please pull up the **[Tone Knob]** to activate the coil split (see the picture below)

Pull up activate

The coil split has been activated

Neck pickup position

Middle pickup position

Bridge pickup position

Neck pickup position:
The second pickup is activated.
Middle pickup position:
The two middle pickups are activated.
Bridge pickup position:
The third pickup is activated.

Volume and Tone

You can use the **[Volume Knob]** to adjust the volume.

Volume adjustment: Turning clockwise increases the volume, and turning counterclockwise decreases it.

Rotate clockwise to increase the volume

Rotate counterclockwise to decrease the volume

You can use the **[Tone Knob/Push-pull for Coil Split]** to adjust the tone.

Tone adjustment: Turn clockwise to increase the treble and counterclockwise to decrease it.

Rotate clockwise to increase the treble

Rotate counterclockwise to decrease the treble

Guitar Pitch Adjustment

You can use the **[Tuning Pegs]** to adjust the tightness of the strings to change the pitch of the guitar.

If the pitch is lower than the target pitch, the **[Tuning Pegs]** of the sixth, fifth and fourth strings need to be turned counterclockwise, and those of the first, second and third strings need to be turned clockwise to increase the pitch.

Twist the sixth, fifth and fourth strings counterclockwise

Twist the first, second and third strings clockwise

The pitch will increase

If the pitch is higher than the target pitch, you need to turn the **[Tuning Pegs]** of the sixth, fifth and fourth strings clockwise and the **[Tuning Pegs]** of the first, second and third strings counterclockwise, and the pitch will decrease.

Twist the sixth string, the fifth string and the fourth string clockwise

Twist the first, second and third strings counterclockwise

The pitch will decrease

Note: When adjusting the wheel-style truss rod, please observe and adjust slowly to avoid damaging the strings and steel bars.

Guitar Action Adjustment

If you need to adjust the height of the strings, please use the included 1.5mm hex key to adjust the screws on either side of the bridge saddle (Turning clockwise raises it, and turning counterclockwise lowers it).

Increase clockwise

Decrease counterclockwise

Intonation Adjustment

Tune all the strings and play the open strings and the 12th fret (or 12th fret overtone) respectively.

If there is a difference in pitch between the open strings and the 12th fret, you need to loosen the strings first, then release the octave adjustment screw that fixes the bridge saddle for adjustment. If the 12th fret is too high or the 12th fret overtone is too high, you need to move bridge saddle towards the tail of the instrument to a suitable position. If the 12th fret is too low or the 12th fret overtone is too low, then the bridge saddle needs to be moved towards the headstock to the suitable position.

Adjustment of the Truss Rod

Look from the headstock along the neck towards the bridge and observe whether there is any obvious bending or twisting in the middle of the neck. If you can clearly see that the middle of the neck is concave or convex, you need to use the **[Wheel-Style Truss Rod]** to adjust it.

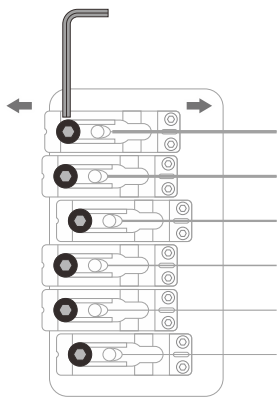
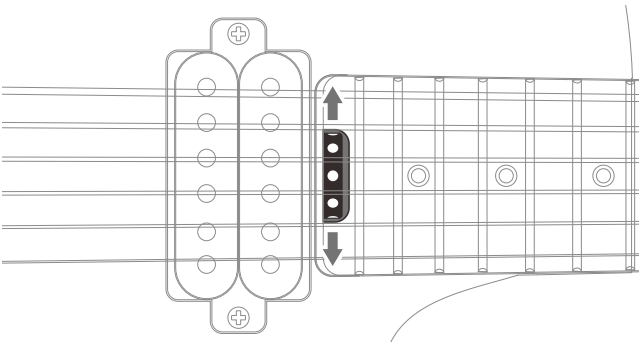

4. Software User Instructions

a) Main Interface

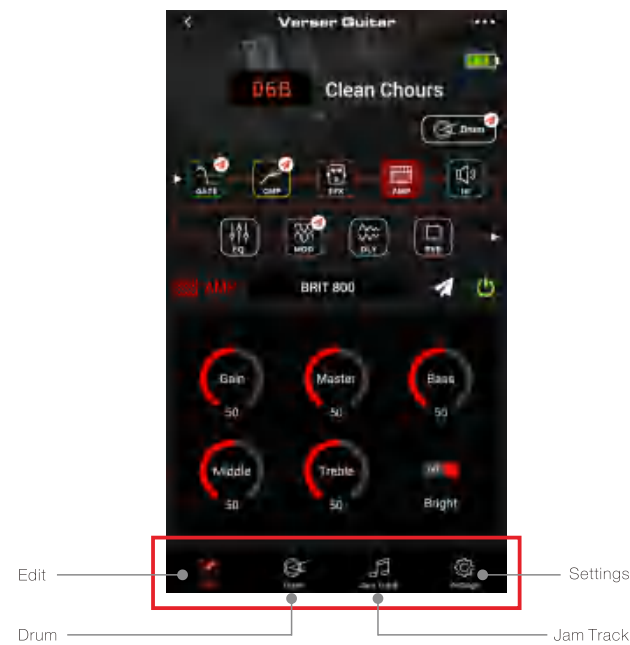

c) USB Audio Settings

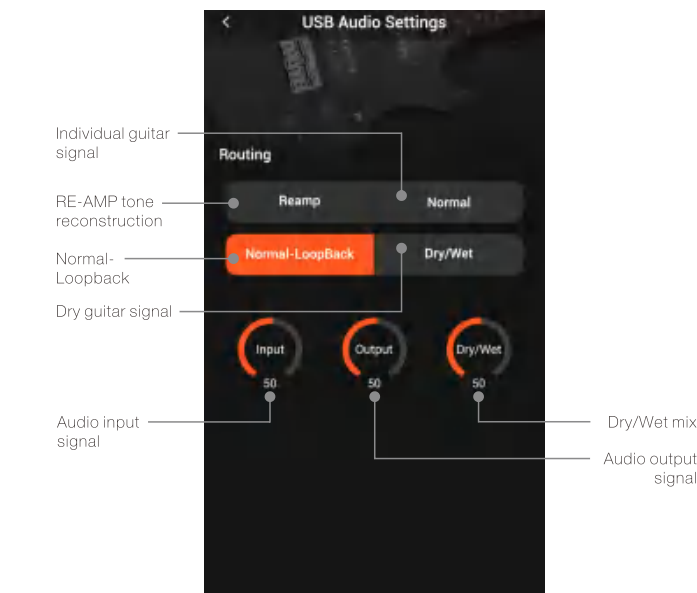

By selecting different modes, you can reprocess the guitar's digital output signal for re-amping and wet/dry monitoring (e.g., record dry while monitoring wet).

b) Software Basic Settings

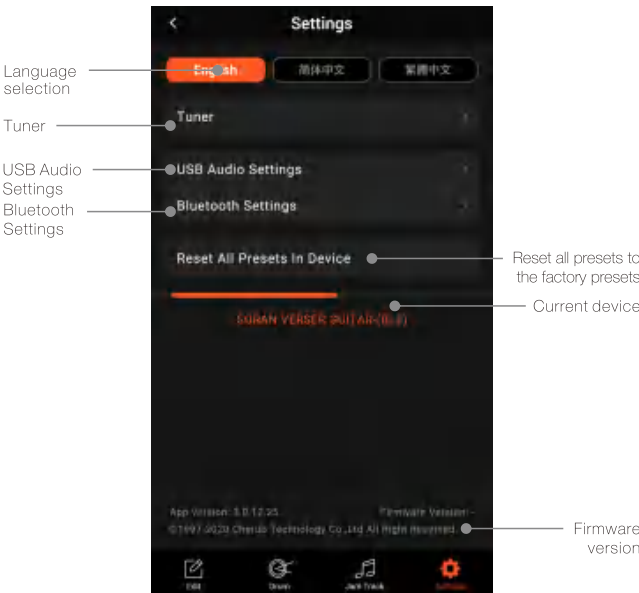

d) BT Wireless Parameter Settings

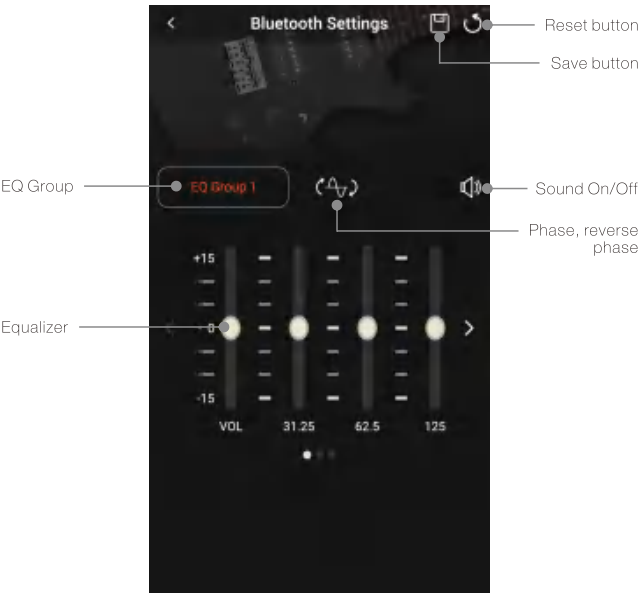

e) Tuner Settings

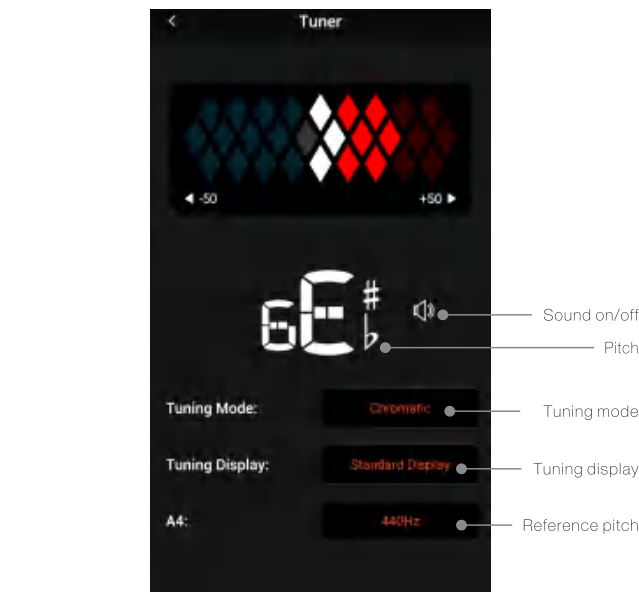

Different display modes and reference pitches allow for tuning of the guitar itself.

g) Basic Information Of Preset

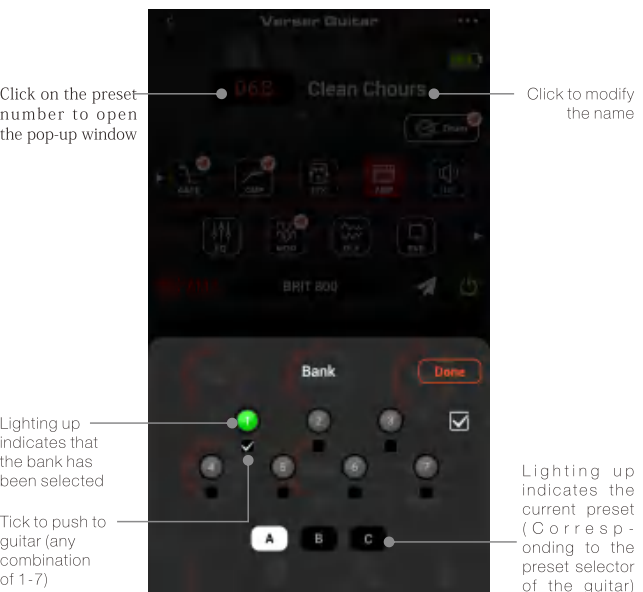

By adopting the 7bank*3preset mode, you can quickly switch between any of the 21 presets.

f) IR Import/Export



h) Import, Export, Save, Reset and Volume

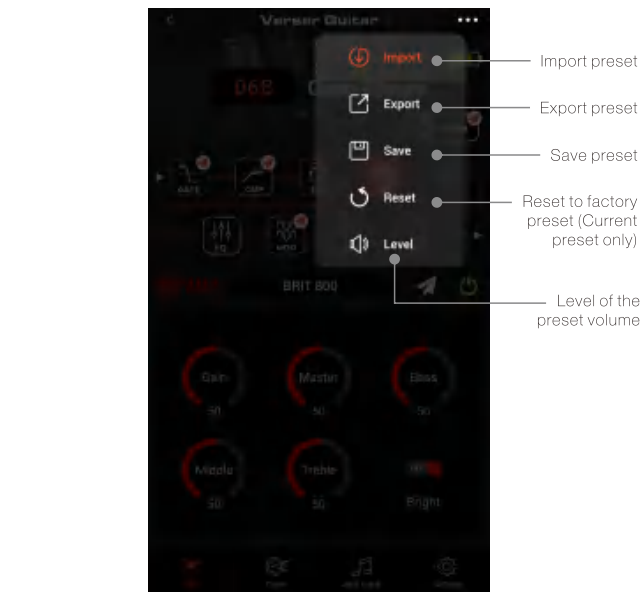

i) User Banks and the Corresponding Presets Within the Banks

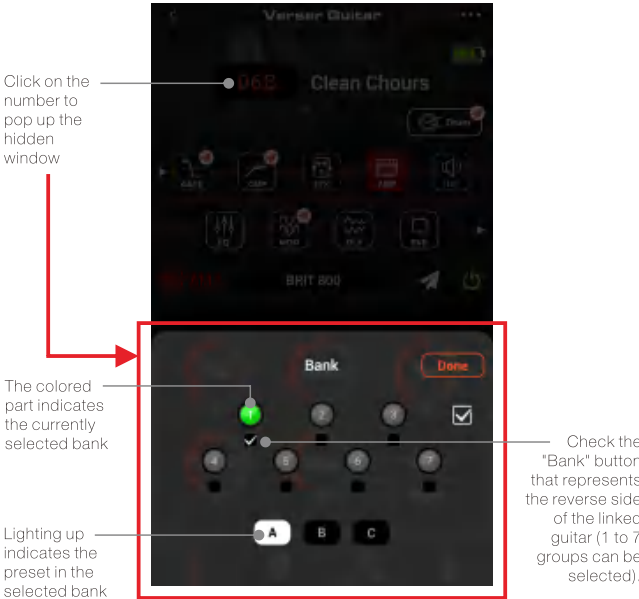

Link the bank button on the side of the guitar, and you can select any combination from groups 1 to 7 to form a loop switch of numbers from low to high.

j) Effect Chain Module, Associated with Guitars and Effect Module Parameters

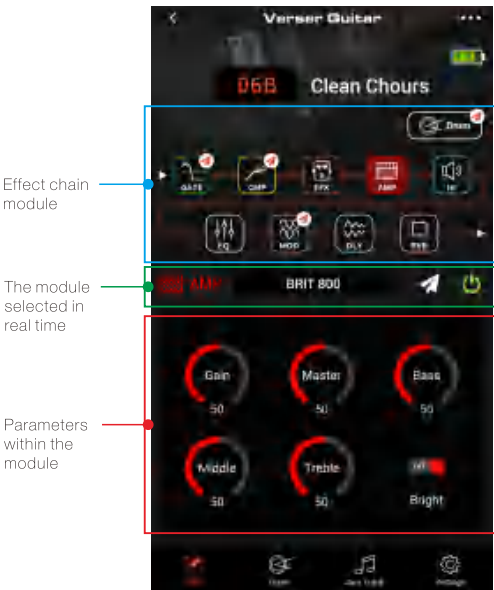

8 effect modules can be sent to the EFX knob of the guitar for simple editing (except for EQ). The color of each module in the APP is the same as the effect light color sent by the guitar. The drum machine can also be added and sent to the EFX knob for simple editing.

Effect chain module: This device consists of nine effect modules, supporting all of them to be turned on simultaneously, and the connection sequence can be changed by dragging and dropping.



k) Save Presets

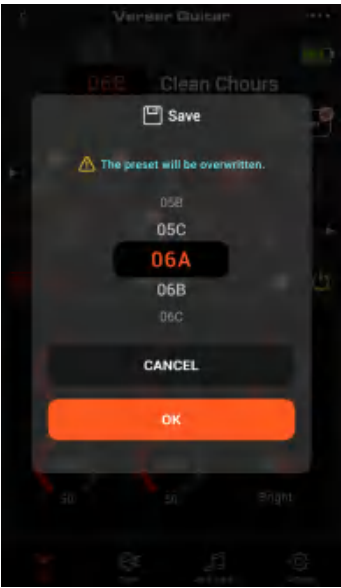

After clicking the "Save" button, you can slide up and down to the position where you need to save, and click OK to complete the saving (the original preset saved here will be overwritten).

Clicking "CANCEL" will exit the save.

l) Reset

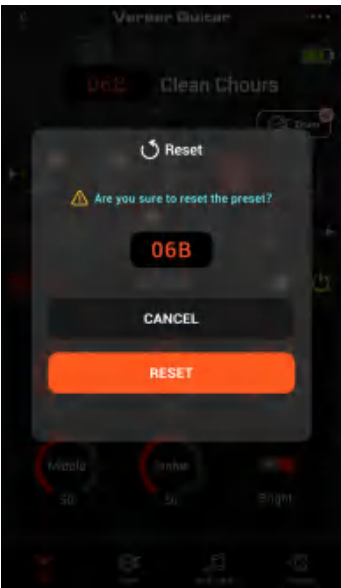

After clicking the "Reset" button, click the "Reset" button again, and the current preset will be reset to the factory preset.

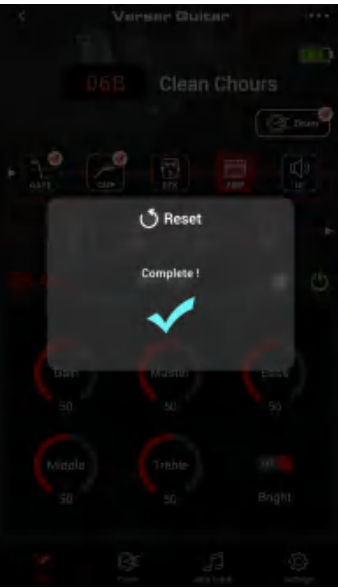

Clicking "CANCEL" will exit the reset.

m) Drum Machine

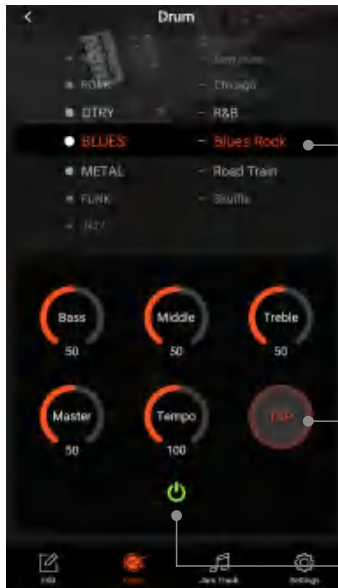

Slide up and down to the target drum set

Speed-aware button: Double-clicking the drum set consecutively adjusts the tempo.

Drum machine On/Off button

n) Jam Track

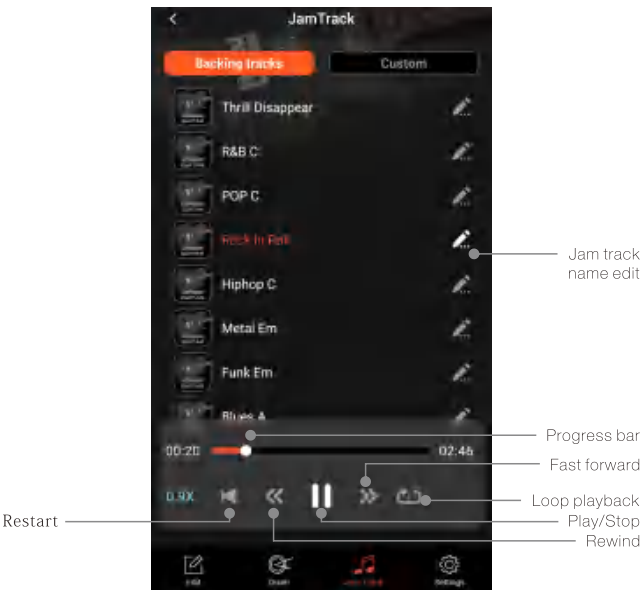

It consists of factory group accompaniment and user group accompaniment. The user group can customize the import of audio, and each accompaniment supports variable speed function.

5. Specifications

Intelligent System

Frequency Response	20Hz-20kHz
Digital Audio	Bit rate: 24-bit , Sampling rate: 48kHz
Effect Modules	9
Effects	110
Presets	21
IR Performance	Bit Rate: 24-bit, Sampling Points: 512, Support 18 user IRs
Drum Machine Rhythmtype	75 styles incl. metronome
EFX Knob	Edit the main parameters of the effect module
Buttons	ENERGY power switch button, BT/DRUM button, BANK switch button
Outputs	1/4" (6.35mm) mono output x 1, 1/8" (3.5mm) stereo phones output x 1
USB-C	USB 2.0 Type-C
Power	5V USB or built-in lithium battery
Lithium Battery	3.7V / 3000mAh
Battery Life	Max.9 hours

Guitar

Body	Melia azedarach
Neck	Quartersawn roasted maple wood/ mahogany
Fretboard	Rosewood
Number of frets	22
Bridge	Customized steel double-string fixed bridge
Knob	1:23 Open gear (3:3)
Frets	Nickel-copper, medium
Pickup	Alnico V humbucker pickup (with coil split)
Circuit function	Volume knob, tone/coil split knob, pickup selector
Sizes	955(L) x 325(W) x 70(H)mm
Net weight	≈3.2kg

*Specifications are Subject to Change Without Notice.

Accessories: Hex key x 1, Truss rod adjustment tool x 1, Type-C data cable x 1.

6. Effect List

Amp Modeling

Amp modeling: Utilizing the unique white-box modeling technology, it can simulate the details of classic tube speakers and classic transistors with excellence, enabling you to handle with ease whether using Clear tone, British distortion, American high-gain, or even bass.

Amp Modeling	FIREMAN HBE
JAZZ CLEAN	DUAL RECT
DELUXE RVB	DIE VH4
BASSMATE	VIBRO KING
TWEEDY	BUDDA
TWIN RVB	MR.Z 38
HIWIRE	SUPER RVB
CALI CRUNCH	BRIT BLUES
CLASS A15	MATCH
CLASS A30	BRIT 2000
PLEXI 100	UBER
PLEXI 45	AGL
BRIT 800	MLD
1987 X 50	Acoustic Preamp
SLO 100	



Impulse Response

Impulse response: By establishing data through real impulse sampling, it achieves more accurate reproduction of the preset details of the speaker!

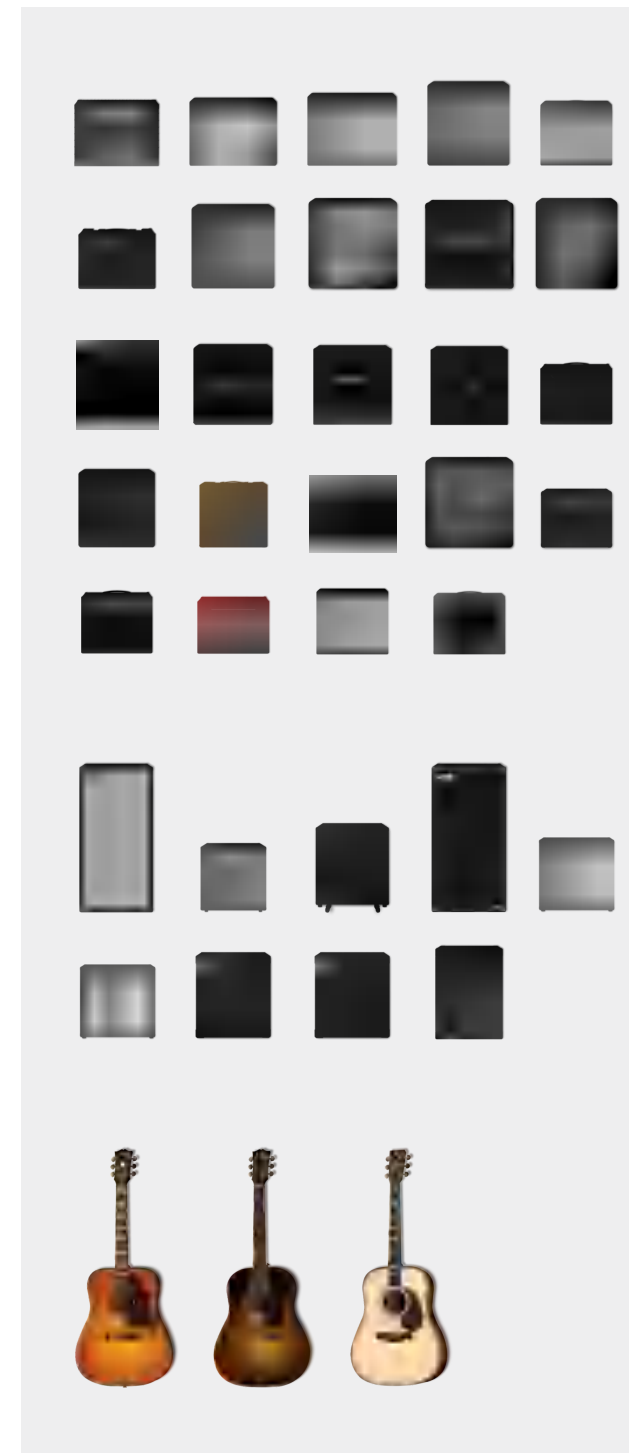

Guitar Amplifier Cabinet	Bass speaker cabinet
Jz120	AGL_DB810
Dr112	AMP_SV212
Tr212	AMP_SV410
HIWIRE412	AMP_SV810
CALI 112	BASSGUY410
A112	EDEN410
GB412	MKB410
M1960AX	
M1960AV	Acoustic guitar sampling
M1960TV	
SLO412	
FIREMAN 412	G-J15
RECT 412	M-D45
DIE412	
MATCH212	Customized pulse sampling
UBER412	
BS410	Bogna-T75
A212	BritJH-G12M
M1960AHW	
M1936	Sampling standard
BUDDA112	
Z212	512
SUPERVERB410	
VIBROKING310	
AGL_DB810	
AMP_SV212	
AMP_SV410	
AMP_SV810	
BASSGUY410	
EDEN410	
MKB410	

Effect Module

The effect modules consist of: Noise Gate, Compression, EFX Module, Equalization, Modulation, Delay, and Reverb.

GATE	MOD
NOISE GATE	CE-1
	CE-2
CMP	ST.CHORUS
ROSE COMP	VIBRATO
K COMP	DETUNE
STUDIO COMP	FLANGER
	PHASE 90
	PHASE 100
EFX	S.C.F
DISTORTION+	U-VIBE
RC BOOST	TREMOLO
AC BOOST	ROTARY SPEAKER
DIST ONE	SCH-1
T SCREAM	MONO OCTAVE
BLUES DRV	
MORNING DRV	DLY
EAT DIST	ANALOG DELAY
RED DIRT	DIGITAL DELAY
CRUNCH	MODULATION
MUFF FUZZ	TAPE ECHO
KATANA	PAN DELAY
ST SINGER	PHI DELAY
TOUCH WAH	
EQ	RVB
6-BAND EQ	ROOM
10-BAND EQ	HALL
	PLATE
	SPRING
	SHIMMER
	DAMP



For CMP (Circuit Modeling Processing) and dynamically based EFX (Effectors), the white-box algorithm can reproduce the playability and response characteristics of the original analog circuit. This device features over 40 effects, ranging from classic overdrive, ethereal or mysterious modulation effects to smooth reverb and more.